

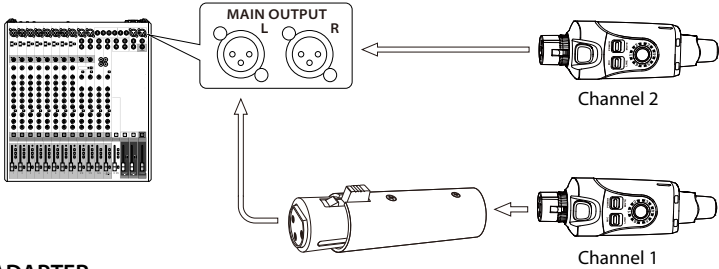

XLR FEMALE TO XLR MALE ADAPTER

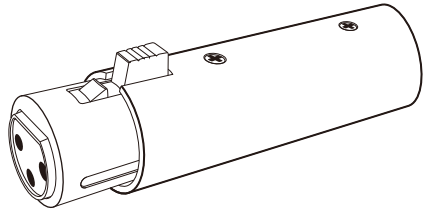

ADAPTER

If the XLR inputs/outputs on your mixer are very close to each other, using the XLR adapter with a transmitter/receiver allows you to plug in two transmitters/receivers side-by-side.

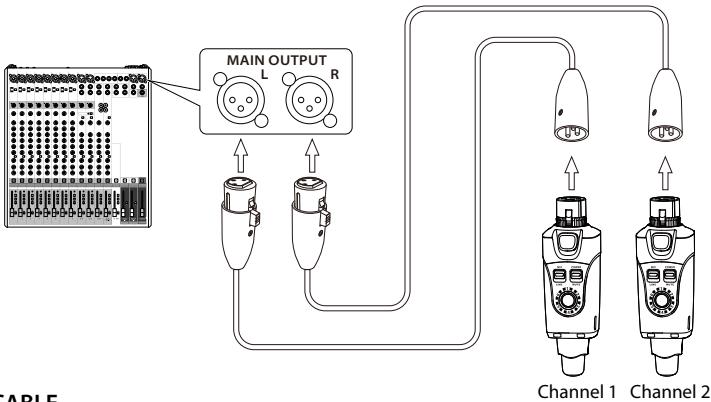

CABLE

Using an XLR cable (not included) as an extension for a transmitter or receiver allows you to connect the components to a mixer where the inputs/outputs are very close together. It can also resolve wireless signal interference issues if you have too many wireless units in close proximity to each other.